

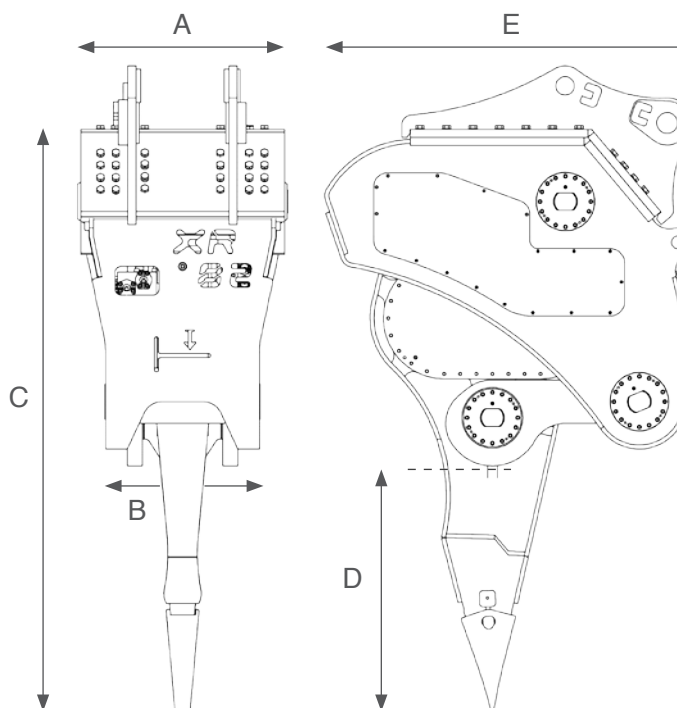

XR 32



TECHNICAL SPECIFICATIONS		XR32
Excavator weight	Tons	24 - 32
Ripper operating weight	kg	3.700
Hydraulic working pressure	MPa	24
Hydraulic oil flow	L/min	190
Frecuency	1/min	1.100



XR32	
A	775
B	635
C	2.715
D	1.160
E	1.660

* Dimensions in millimeters.

XCENTRIC RIPPER INTERNATIONAL, S.L.

Arriurdina, 15 · 01015 Vitoria-Gasteiz (Spain) · Tel.: +34 945 290 555

www.xcentricripper.com