

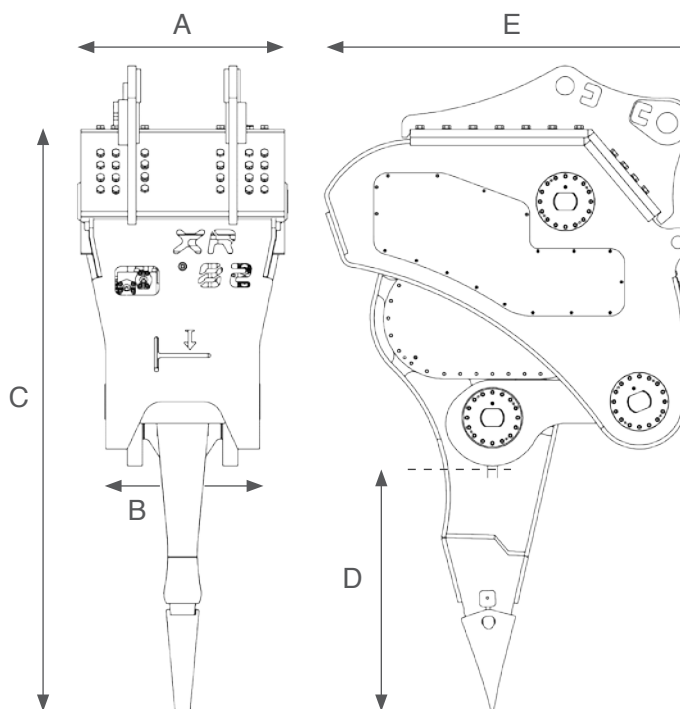

# XR 52



TECHNICAL SPECIFICATIONS		XR52
Excavator weight	Tons	40 - 55
Ripper operating weight	kg	4.900
Hydraulic working pressure	MPa	28
Hydraulic oil flow	L/min	270
Frecuency	1/min	1.100



XR52	
<b>A</b>	960
<b>B</b>	630
<b>C</b>	3.000
<b>D</b>	1.315
<b>E</b>	1.830

\* Dimensions in millimeters.

**XCENTRIC RIPPER INTERNATIONAL, S.L.**

Arriurdina, 15 · 01015 Vitoria-Gasteiz (Spain) · Tel.: +34 945 290 555

[www.xcentricripper.com](http://www.xcentricripper.com)