

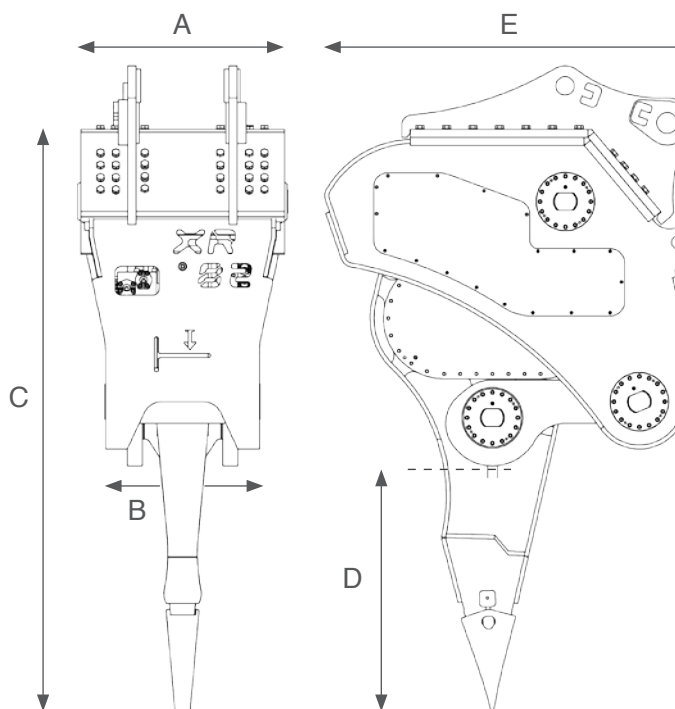

XR 82



TECHNICAL SPECIFICATIONS		XR82
Excavator weight	Tons	70 - 90
Ripper operating weight	kg	10.000
Hydraulic working pressure	MPa	30
Hydraulic oil flow	L/min	420
Frecuency	1/min	700



XR82	
A	1.270
B	960
C	3.575
D	1.530
E	2.300

* Dimensions in millimeters.

XCENTRIC RIPPER INTERNATIONAL, S.L.

Arriurdina, 15 · 01015 Vitoria-Gasteiz (Spain) · Tel.: +34 945 290 555

www.xcentricripper.com